

# MAX-ILS SERIES

SURFACE OR FLANGE MOUNTED MAXIMUM SECURITY



# MAXIMUM SECURITY

Also Suitable for Cleanrooms & Food Processing

Specifier's Reference	
Project Name	Type
Catalog No.	
Comments	

- **Listings/Certifications:** ETL(US/Canada), damp location listed

## Specifications

- **Housing:** 14-gauge cold rolled steel housing with continuous welded seams.
- **Door:** 14-gauge cold rolled steel door with continuous hinge. Stainless hinge available.
- **Lens:** 2X2 - Standard .125" thick clear prismatic acrylic with smooth side exposed to facilitate cleaning. Continuous formed channels for positive retention. 15" Square - Triumph II .125 clear polycarbonate lens. Optional lensing shown below.
- **Gasket:** Closed cell neoprene sponge gasket around door and hinge.
- **Door Latch Screws:** Standard allen head center pin reject screws to secure door.
- **Lamps:** Magnetic induction lamps by other. Note: 100W induction lamp produces 11,000 lumens when used with the 150W generator. See below for lamping options.
- **Generator:** Standard instant on and restrike, universal voltage 120V through 277V, 100% power factor. Low harmonic distortion.
- **Finish:** Standard baked white polyester powder coat paint finish. Optional Agion® antimicrobial finish available.
- **Mounting:** Surface unit has (4) 5/16" Diameter mounting holes provided, with 1/2" knockout for wiring. Flange unit has two cross mounting channels. Optional plaster frame available. All hardware by others.

## Ordering Information

Example: **MAX - ILS - 22 - 1 - 100 - 150 - 4/A - AL - UNV**

Series	Size	Number Lamps	Lamp Type	Generator Type	Lens Type	Fasteners	Options	Voltage	
<b>MAX-ILS</b>	<input type="text"/>	<input type="text"/>	<input type="text"/>	<input type="text"/>	<input type="text"/>	<input type="text"/>	<input type="text"/>	<input type="text"/>	
	<b>-22</b> 2 X 2 Unit	<b>-1</b> One Lamp	<b>-100</b> 100W Induction Lamp	<b>-100</b> 100W Generator	<b>2X2</b> <b>ENVIRONMENT SIDE</b> <b>-4</b> .375 Clear Polycarbon- ate (standard) <b>-8</b> .375" Clear Tempered Glass <b>LAMP SIDE</b> <b>-A</b> .125 Prismatic Polycarbonate <b>-C</b> .140 DR Prismatic Acrylic <b>-G</b> .156 Prismatic Tempered Glass <b>-UV</b> .007 UV Absorbing Overlay	<b>15"</b> <b>SQUARE</b> <b>-TR</b> Triumph II .125 clear polycarbonate lens.	<b>-F1</b> Allen Head - center pin reject, standard <b>-SF</b> Specified Fastener	<b>-SS</b> 18ga Stainless Steel Housing with 18ga Brushed Flange, Brushed Stainless Steel Door <b>-AL</b> 16ga Painted Aluminum Housing, 16ga Painted Aluminum Door <b>-AG</b> AgION™ Antimicrobial Protection in Powder Coat Paint <b>-PF</b> Plaster Frame (only available with flange units) <b>-WL</b> Wet Location	<b>-UNV</b>

Note: Contact Factory For Additional Configurations.

**Morlite**  
TOUGH SITES ..... TOUGH LITES

1805 Pittsburgh Ave, Erie, PA 16502 • 800-865-5954 • Fax 800-667-9959



# MAX-ILS SERIES

SURFACE OR FLANGE MOUNTED MAXIMUM SECURITY



## Dimensions & Mounting

2X2 Surface

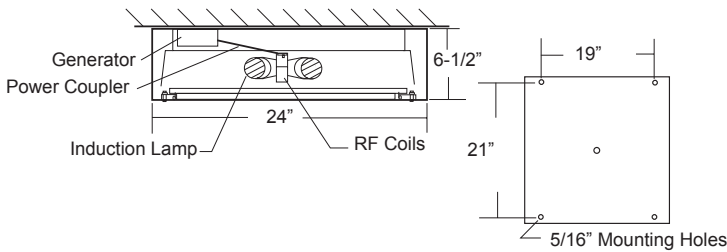

15" Square Flange

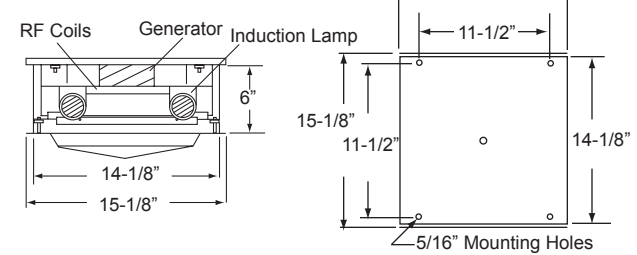

## Photometry

**Catalog #MAX-ILS-22-1-100-150**  
**Luminaire Efficiency: 68.2%**  
**Lamps: 1 - FO32/T8/735**  
**Lumens per Lamp: 11,000**  
**Ballast Factor: 1.0**

Floor	20%				70%				50%					
	70	50	30	10	70	50	30	10	50	30	10	50	30	10
0	81	81	81	81	79	79	79	79	75	75	75	75	75	75
1	75	72	70	68	73	71	69	67	68	66	65	65	65	65
2	69	65	61	57	68	63	60	57	61	58	55	55	55	55
3	64	58	53	49	63	57	52	49	55	51	48	48	48	48
4	59	52	47	43	58	51	46	43	50	45	42	42	42	42
5	55	47	42	38	54	46	41	38	45	41	37	37	37	37
6	51	43	37	33	50	42	37	33	41	37	33	33	33	33
7	48	39	34	30	47	39	34	30	38	33	30	30	30	30
8	44	36	31	27	43	36	30	27	35	30	27	27	27	27
9	42	33	28	24	41	33	28	24	32	27	24	24	24	24
10	39	31	26	22	38	30	26	22	30	25	22	22	22	22

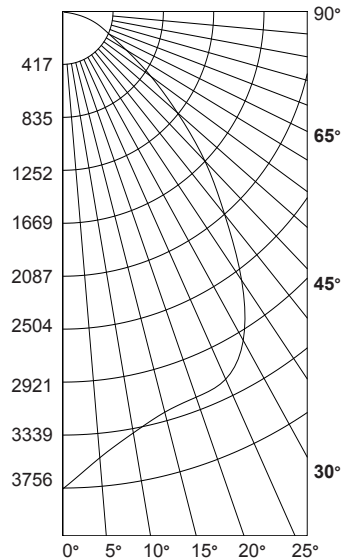

## Technical Information

### About Induction Lamps:

The induction lamp operates without an electrode. Outside the lamp are the RF induction coils, powered by a generator within the fixture housing, which produces an RF magnetic field that produces light. This coil is sometimes referred to as an energy-coupling antenna. The glass assembly surrounding the induction coil contains a mercury electron-ion plasma material, which is energized in a magnetic field producing UV light. The inner portion of the glass is lined with a tri-phosphor coating very similar to that in fluorescent lamps.

The induction lamp offers many features that make it an attractive light source. With such a long rated life, these lamps seldom need replacing, rendering them virtually maintenance-free. This is particularly useful in in hard-to-reach areas and applications where lamp replacement is cumbersome and expensive, as in some applications such as cleanrooms and food processing areas.

The induction lamp is also durable, and its light output is not significantly influenced by ambient temperature. This makes the induction lamp ideal for outdoor applications, where durability is certainly a high priority.

- Ultra-long life – 100,000 hours rated life
- White light, excellent color rendering (80+ CRI) with choice of color temperatures
- No color shift
- High reliability – instant start when cold and re-starting when hot
- Low EMI complies with FCC Non-Consumer Limits .

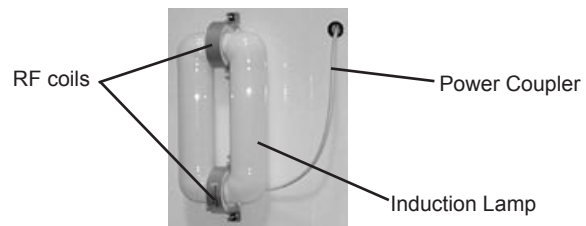

**Antimicrobial:** Optional Agion® Antimicrobial protection using silver technology inhibits bacterial colonization on metal interior and exterior surfaces. Agion® antimicrobial FDA recognized and EPA registered, meeting all applicable EPA standards.

