

SH1206 SECURITY EXIT SIGN

Single or Double Faced Signage

MEDIUM SECURITY



Specifier's Reference

Project Name	Type
Catalog No.	
Comments	

- **Listings/Certifications:** ETL (US/Canada) listing

Specifications

- **Housing:** 14 gauge one-piece, die-formed and welded cold rolled steel. All exposed seams MIG welded and ground smooth.
- **Door:** One-piece, die-formed 14-gauge prime cold rolled steel.
- **Hinge:** 16-gauge, 1/4" diameter knuckle, continuous piano hinge with welded pin ends. Hinge welded to housing and door.
- **Lens:** 1/8" clear polycarbonate with white translucent acrylic overlay. Red silk-screened letters on acrylic panel. Directional arrows available. Optional 1/8" clear prismatic lens provides downlight.
- **Lens Retention:** 14-gauge, vertically adjustable "Z" shaped retaining angles. Retaining angles secured with through studs and die-cast locknuts.
- **Fasteners:** Two captive center pin reject. Allen head fasteners with nutholders.
- **Lamps:** Fluorescent lamp model, lamps supplied by others. LED model includes special high intensity red or green LED panel.
- **Finish:** Standard baked white polyester powder coat paint finish. Gloss 85%, reflectance 90%, salt spray 1000 hours.

Ordering Information

Example: **SH1206 - 2PL7 - SF - BWM - F1 - DW - 120V**

Series	Lamp	Sides	Mounting	Fasteners	Options	Voltage
SH1206						
	-2PL7 2-7W PL G23d Base	-SF Single Face	-BWM Back Wall Mounted	-F1 Allen Head Center Pin Reject Standard	-GW Green Letters	-120V
	-LED 2-LED's 4.8 Watts @ 120V 4.6 Watts @ 277V	-DF Double Face	-CM Ceiling Mount	-SP Specified Fastener	-EMG Emergency Battery Pak for Fluorescent units only	-277V
			-EM End & Wall Mounted		-SS Stainless Construction	
					-DW Clear Prismatic Downlight Lens	
					-DL Damp Location Unit	
					-WL Wet Location Unit	



1805 Pittsburgh Ave, Erie, PA 16502 • 800-865-5954 • Fax 800-667-9959



SH1206 SECURITY EXIT SIGN

Single or Double Faced Signage



Dimensions & Mounting

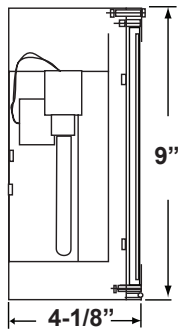

SINGLE FACE

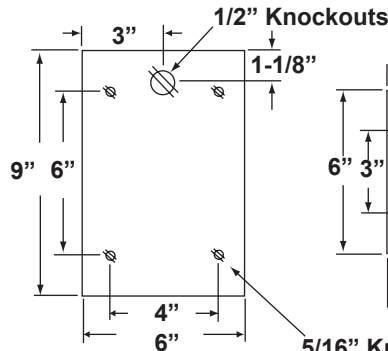

END MTD

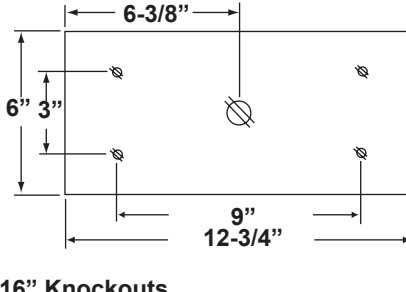

CEILING MTD

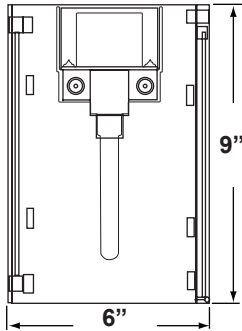

DOUBLE FACE

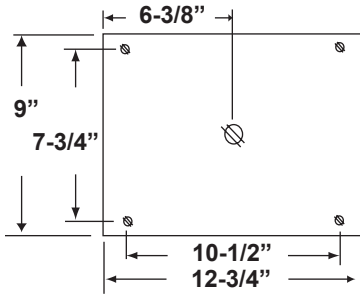

WALL MTD

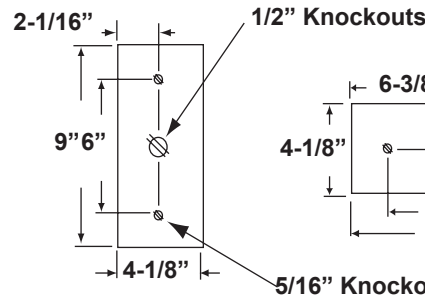

END MTD

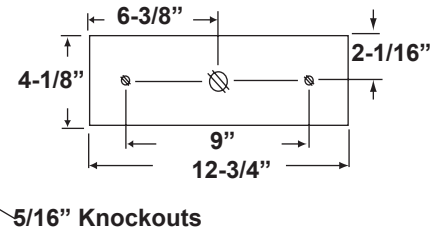

CEILING MTD

Features



Optional clear prismatic downlight lens.



14-gauge lapped and welded seam construction results in a fixture of unmatched strength and rigidity.



"Z" shaped lens retainers, through studs and die-cast locknuts produces secure, dependable lens retention system.